



How To

ASSEMBLE THE RAILSCALE33D N GAUGE OTA WAGON

Assembling this wagon should take no longer than 7 minutes, and depending on what livery you paint it in, the total time to produce one wagon can be around 20 minutes, that's quicker than driving down to the local hobby shop for a RTR OTA wagon (oh wait, there is no RTR OTA wagons), or waiting two days for your parcel to arrive, in the period it takes for your parcel to arrive you could have made 144 wagons...

Enjoy this easy to build kit!

Anything missing from the kit or if anything has been broken and you require spare parts, please don't hesitate to contact me

Email: railscale33d@gmail.com

Web: railscale33d.com/contact

Last updated: (19/01/24)



1



In your kit you should have all these components:
x1 Chassis, x2 End parts, x2 Handbrake details,
x18 Log poles.

2



I have decided to paint my OTA wagon in the EWS livery, thanks to the airbrush I have got a real good looking paint job (almost looks factory)

3

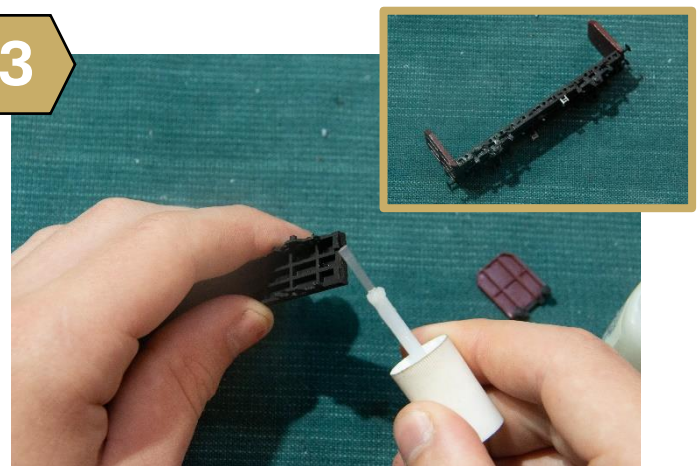

I start off by glueing the two end parts on, I am using generic fast setting super glue, make sure to check that the end parts are 90° to the chassis.

4

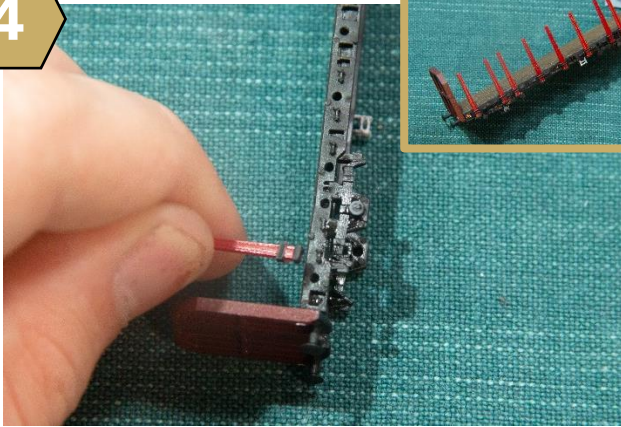

Here I am attaching the log poles to the chassis, this is done by putting glue on the pin at the bottom of the log poles and inserting them into their designated holes in the chassis.

5

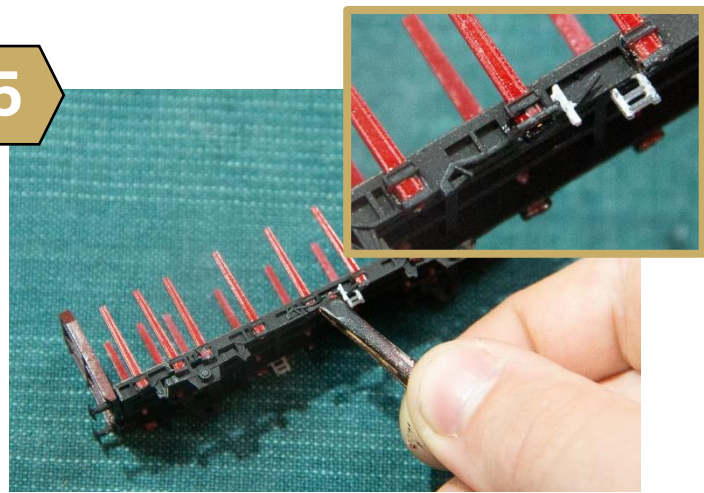

Now it's the "turn" of the handbrake (see what I did there). Hard to see in the photo but this is simply stuck on with super glue (see the insert image for position - it kind of wraps around the log pole)

6

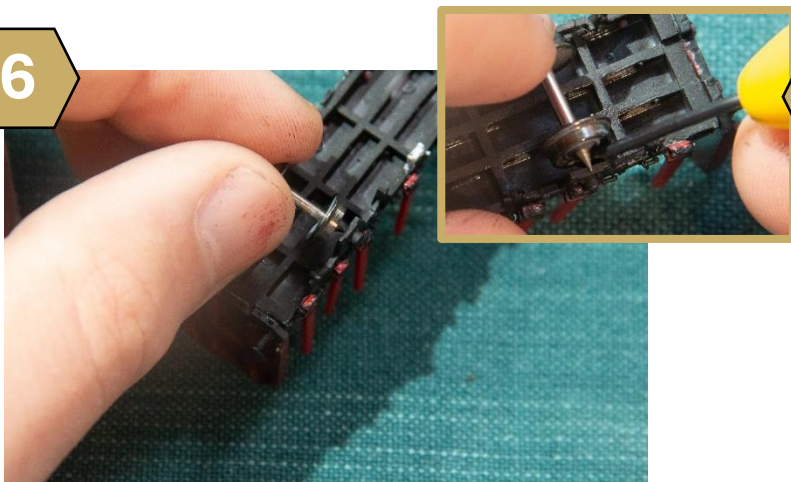

Inserting the wheels is best when you push one side in and then try to push the other side in, don't push both sides in at once (if it helps, maybe try prying the axle box away a little - see insert image). These are standard Graham Farish Wheels

7

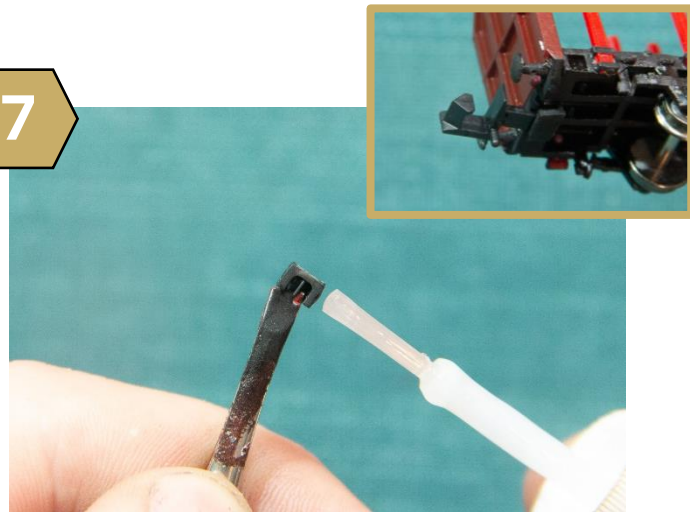

For couplers I have decided to use NEM pockets, these particular NEM pockets I am using are Railscale33d's design, they are nothing different and are dimensionally the same, they are however a lot cheaper. These are simply glued on, and the coupler of choice is added (see insert photo)

8



And there we are, A finished OTA Wagon.